

IMPORTANT NOTE:

This Quick Start Guide is NOT intended to replace the content included in the instruction manual. You should read the instruction manual completely before proceeding.

1. CHARGING THE BATTERIES

Power the SC3500-3 charger from a 100-240V AC outlet using the AC adapter/power supply, or from a 12V DC accessory socket/cigarette lighter receptacle in a vehicle using the included adapter.



2. PREPARING THE CGO3

- 2.1 Remove the cover/lock from the rear of the CGO3 by carefully sliding it backward.
2.2 Insert the included 14GB card or any Class 10 microSD card from 16GB to 128GB.
2.3 Carefully remove the protective material from the camera lens.

3. INSTALLING THE PROPELLERS

Install the corresponding A and B propellers in the positions shown by rotating them per the illustration and until they're secure. It may also be helpful to use the included tool to hold the motors while installing the propellers.

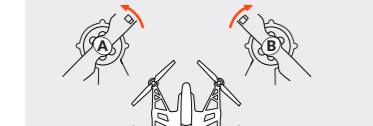

A green blinking LED indicates the charger is powered on and ready to charge, and a red blinking LED indicates the battery is charging. It will take approximately 2 hours to charge a fully discharged (not over-discharged) battery.

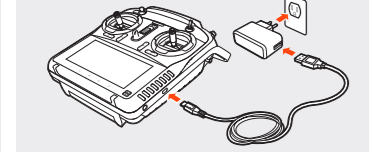

NOTICE: The adapter is sold separately.
WARNING: All instructions and warnings must be followed exactly to prevent property damage and/or serious injury as the mishandling of Li-ion/LiPo batteries can result in fire.

CAUTION: Do not over-tighten the propellers when using the tool.

4. INSTALLING THE BATTERY

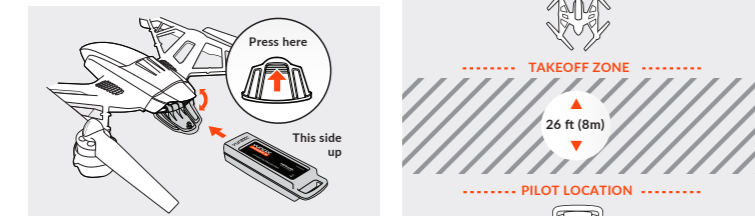

NOTE: If the door does not close, the battery is not inserted far enough to engage the connector properly.

5. PLACEMENT BEFORE TAKEOFF

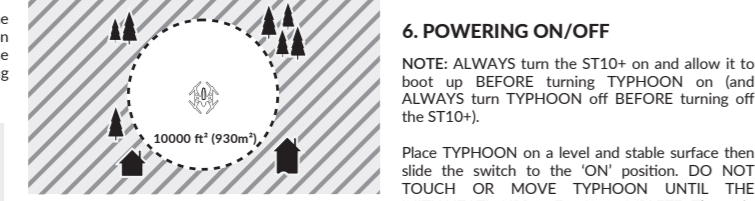

WARNING: Always operate TYPHOON in open areas (approximately 10000 square feet/930 square meters or more) that are free from people, vehicles, trees and other obstructions. Never fly near or above crowds, airports or buildings.

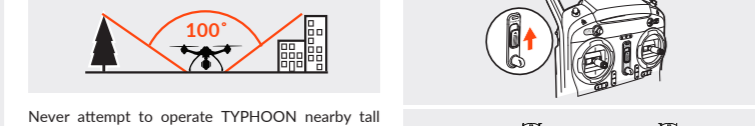

Never attempt to operate TYPHOON nearby tall buildings/obstructions that do not offer a clear view of the sky (a minimum clearance of 100°).
Be sure to place TYPHOON on a level and stable surface before powering ON the Controller and Aircraft.

If indoor flight is needed, please turn off the GPS first. Press setting button on ST10+ interface and switch off the GPS.

When the CGO3 and ST10+, the multi-copter and ST10+ are bound, press 8 - optional calibration of video settings and Audio Switch will be shown above.

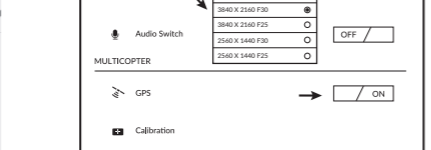

If calibration is needed before flight, Please press calibration button enables the user to enter Compass calibration or Accelerometer calibration. The detailed calibration operation can be referred to the User Manual on www.yuneec.com.

7. STARTING/STOPPING THE MOTORS

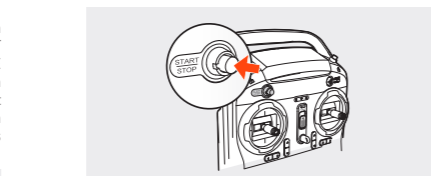

Step back approximately 26 feet (8 meters) behind TYPHOON.
Step back approximately 26 feet (8 meters) behind TYPHOON. Press and hold the red START/STOP button for about 3 seconds to start, and about 2 seconds to stop the motors.

8. FLIGHT CONTROLS

To takeoff, slowly raise the left-hand stick to slightly above the center position. TYPHOON will takeoff and climb slowly (or raise the stick further until it dings). Allow the stick to return to the center position when TYPHOON reaches the desired altitude.

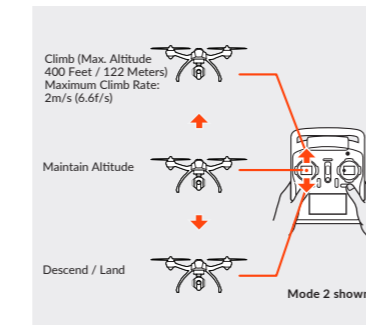

FLYING

Take your time learning how TYPHOON responds to various control inputs while flying. In Smart Mode TYPHOON will always move in the direction the right-hand control stick is pushed relative to the pilot and no matter which way the front/nose is pointed. In Angle (Pilot) Mode TYPHOON will move in the direction the control stick is pushed relative to the front/nose of the aircraft (and 'angle' of movement is determined by how far you push the stick away from the center position). And please see the corresponding sections of this instruction manual for more information on Smart Mode and Angle (Pilot) Mode.



9. CONTROL RATE SLIDER

Set the overall climb/descent and directional control rates. Use the turtle position for the lowest control rates (best for first-time pilots and when flying between 5000 feet and 8000 feet Above Mean Sea Level). Use the rabbit position for the highest control rates (best for experienced pilots and only when flying below 5000 feet AMSL).



LANDING

There are two ways to land TYPHOON:

- 1) Position TYPHOON above the area where you would like to land. Slowly lower the left-hand stick to below the center position. TYPHOON will descend slowly and land. After TYPHOON lands, press and hold the red START/STOP button until the motor stop.

2) Activate Home Mode and TYPHOON will automatically fly itself back to the home point and will land within a 6.56 foot (2 meter) diameter circle around it.

WARNING: Always land as soon as possible after the first low level voltage battery warning, or land immediately after the second level low voltage battery warning (as indicated by the vibrations and audible alerts from the ST10+, and by the Balow Motor LED Status Indicators flashing rapidly). And if at any time the Aircraft Battery Voltage shown on the screen is below 10.7V, land TYPHOON immediately.

AFTER LANDING

ALWAYS turn off TYPHOON BEFORE turning off the ST10+. Then remove the battery from TYPHOON and allow it to cool to ambient/room temperature before recharging.

11. FLIGHT MODES

SMART MODE: When the Flight Mode Selection Switch is the top position TYPHOON will be in Smart Mode.
ANGLE (PILOT) MODE: When the Flight Mode Selection Switch is the middle position TYPHOON will be in Angle (also known as Pilot) Mode.
When the flight mode switch is in the lowest position TYPHOON will be in Home Mode.

10. SELECTING A FLIGHT MODE

TYPHOON is programmed with three (3) flight modes that can be selected via the Flight Mode Selection Switch located just above the right-hand control stick.

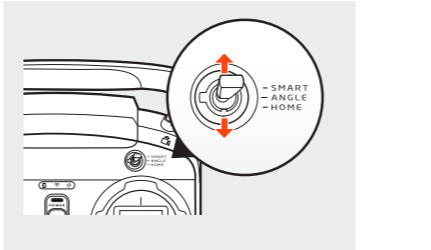

- 1) When the flight mode switch is in the top position TYPHOON will be in Smart Mode.
2) When the flight mode switch is in the middle position TYPHOON will be in Angle (also known as Pilot) Mode.
3) When the flight mode switch is in the lowest position TYPHOON will be in Home Mode.

11. FLIGHT MODES

SMART MODE: When the Flight Mode Selection Switch is the top position TYPHOON will be in Smart Mode.
ANGLE (PILOT) MODE: When the Flight Mode Selection Switch is the middle position TYPHOON will be in Angle (also known as Pilot) Mode.
When the flight mode switch is in the lowest position TYPHOON will be in Home Mode.

This illustration applies when the controller is pointed towards the aircraft

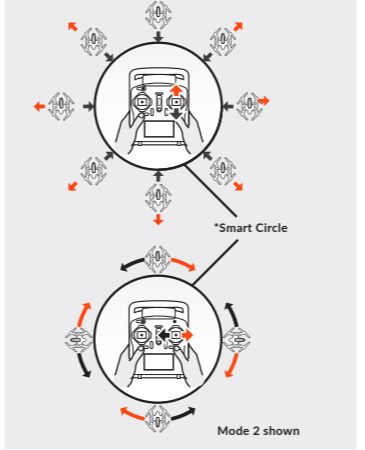

FOLLOW ME FUNCTION

The Follow Me function allows the TYPHOON to follow the pilot, adjusting its location to the location of the ST10+. This function is enabled when ST10+ GPS positioning completes, and the TYPHOON is using shared GPS signal with the ST10+. At this time, you will see orange and green follow in. When in Follow Me function, the TYPHOON will follow the movement of the ST10+ if there is no extra operation on the ST10+. The flight status is also controllable when you operate ST10+ and CGO3.



WATCH ME FUNCTION

Watch Me function enables the camera to keep tracking the remote controller no matter where and how it moves as the camera can automatically tilt its angle according to the controller. This means if the front/nose of TYPHOON is pointing away from you it will move to the left, but if the front/nose is pointing at you TYPHOON will move to the right.

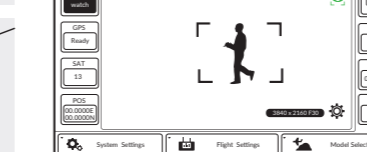
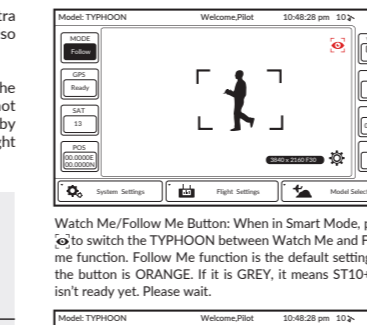
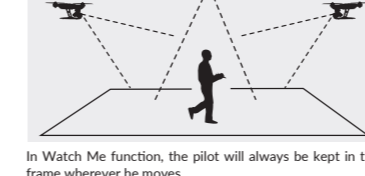

*SMART CIRCLE

In most cases the Smart Circle will keep TYPHOON from coming within approximately 26 feet (8 meters) of you as long as you position yourself at least 26 feet/8 meters behind TYPHOON.

GEO-FENCE

The geo-fence is a virtual 'barrier' that will keep TYPHOON from traveling further than 300 feet (91 meters). Although this limit can be adjusted using the USB interface/programmer and software we strongly recommend using the default limit at all times.

WARNING: Smart Mode only works when TYPHOON has a suitable GPS signal/lock. If you take off in Smart Mode and TYPHOON loses GPS signal/lock it will switch to Angle (Pilot) Mode automatically. This is why we strongly recommend learning to fly in Angle (Pilot) Mode as soon as possible. Otherwise, if you lose GPS signal/lock and are not able to properly control TYPHOON in Angle (Pilot) Mode the aircraft may crash or even 'fly away'.

IMPORTANT NOTE: Crash damage and 'fly aways' are NOT covered under warranty.

ANGLE (PILOT) MODE

When the Flight Mode Selection Switch is the middle position TYPHOON will be in Angle (also known as Pilot) Mode.

Angle (Pilot) Mode is the mode preferred by experienced RC/drone pilots because TYPHOON will have a limited amount of directional control. To help avoid obstacles we strongly recommend to switch to Smart or Angle Mode (when you can switch back to Home Mode).

POSITION HOLD AND SELF-LEVELING

TYPHOON will automatically hold its position (with a suitable GPS signal/lock) and maintain a level attitude (without roll) when the right-hand stick is centered.

WARNING: If you do not properly control TYPHOON in Angle (Pilot) Mode the aircraft may crash or even 'fly away'.

HOME MODE

When the Flight Mode Selection Switch is in the bottom position TYPHOON will be in Home (also known as Return to Home) Mode.

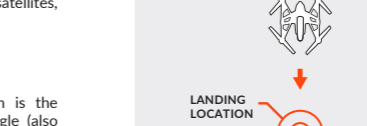

12. CAMERA CONTROLS

Additional Angle (Pilot) Mode Feature:
When Home Mode is activated TYPHOON will respond as follows:

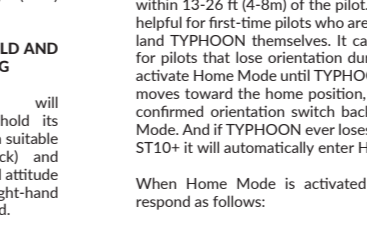

A) When flying higher than 33 feet (10 meters) TYPHOON will maintain the current altitude, fly back to the home point, or active home point if the ST10+ has enough satellites for Follow Me, then descend vertically until it lands.

B) When flying lower than 33 feet (10 meters) TYPHOON will climb to 33 feet (10 meters) while flying back to the home point, or active home position, then will descend vertically until it lands.

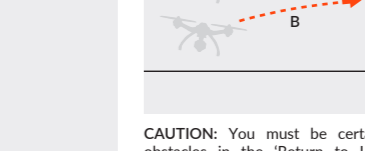

13. ST10+ DISPLAY

1) Flight Mode of Aircraft
2) GPS Status for Aircraft
3) Watch Me/Follow Me Button
4) In Flight Settings

14. CAMERA CONTROLS

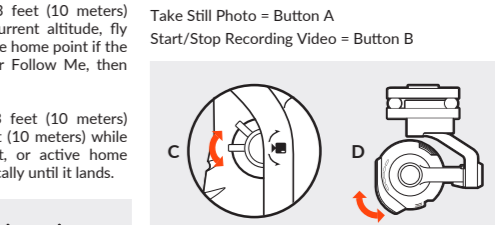
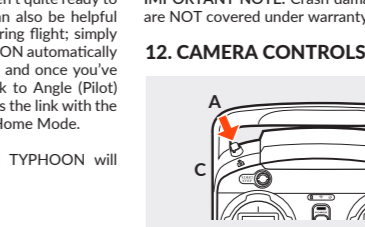

Use the slider (C) on the left side of the ST10+ to set the pitch/tilt position (D) of the CGO3.

CAUTION: In ST10+, the default Camera Mode is CGO3. You MUST stop recording video in order to take still photos and will take 1-2 seconds to capture a still photo and before you can take another.

CAUTION: ALWAYS stop recording video before turning off TYPHOON/CGO3 to avoid data loss. If you accidentally turn off TYPHOON/CGO3 before you stop recording, re-insert microSDCard (if removed) and turn the system on again. Wait approximately 20 seconds until the camera LED starts to glow solid green indicating the last video file was recovered.

NOTE: If you want professional camera application, please choose CGO3 PRO in ST10+ camera selection. For further information on CGO3 PRO, please refer to the Q500 4K USER MANUAL.

14. CAMERA CONTROLS

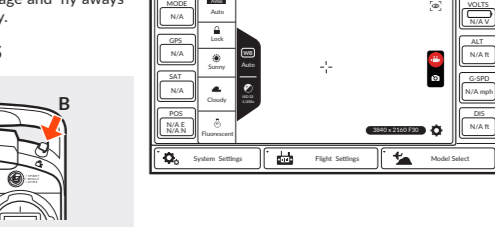

15. CAMERA CONTROLS

WARNING: NEVER attempt to fly TYPHOON via First-Person View (FPV). Attempting to fly via FPV can result in a crash that will cause damage to the product, property and/or cause serious injury.

IMPORTANT NOTE:

After flying, turn off TYPHOON BEFORE turning off the ST10+. Then remove the battery from TYPHOON and allow it to cool to ambient/room temperature before recharging.

DOUBLE TAP

Double tap the center of the screen to increase the size of the video viewing area.

ANY INFORMATION ABOVE MIGHT BE CHANGED DUE TO THE SOFTWARE UPDATES.

FOR THE LATEST DOCUMENTS, PLEASE CHECK THE OFFICIAL WEBSITE.

THE FOLLOWING DOCUMENTS ARE AVAILABLE FOR DOWNLOAD AT WWW.YUNEEC.COM/SUPPORT

- The full TYPHOON Q500 4K Manual
• Calibration Sheet
• LED Status Indication Sheet
• Graphic User Interface
• Firmware Updates
• Tutorial Videos

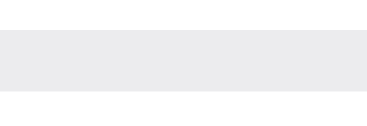

NOTICES AND WARNINGS

IMPORTANT NOTE: All safety precautions and warnings, instructions, warranties and other collateral information is subject to change at the sole discretion of Yuneec. For the most up-to-date information please visit the corresponding product page at www.yuneec.com or contact the nearest Yuneec distributor.

CAUTION: Procedures, which if not properly followed, create a possibility of property damage and/or title to possibility of injury.
WARNING: Procedures, which if not properly followed, create the probability of property damage, collateral damage and/or serious injury or create a high probability of superficial injury.
NOTE: Read the ENTIRE quick start guide and user manual to become familiar with the features of the product before operating. Failure to operate the product correctly can result in damage to the product, property and/or cause serious injury.

GENERAL SAFETY PRECAUTIONS AND WARNINGS
WARNING: Failure to use this product in the intended manner as described in the quick start guide and instruction manual can result in damage to the product, property and/or cause serious injury.

You must always charge the LiPo battery in a safe, well-ventilated area away from flammable materials.
Never charge the LiPo battery unattended at any time. When charging the battery you must always remain in constant observation and be ready to disconnect the battery and remove it from the charging process and react immediately to any potential problems that may occur.

FCC STATEMENT:
This equipment has been tested and found to comply with the limits for Part 15 of the FCC rules. These limits are designed to provide reasonable protection against harmful interference in a residential installation.

RF EXPOSURE WARNING
This equipment must be installed and operated in accordance with provided instructions and the antenna(s) used for this transmitter must be installed to provide a separation distance of at least 20 cm from all persons and must not be co-located or operating in conjunction with any other antenna or transmitter.

QUICK START GUIDE
This equipment complies with IC RSS-102 radiation exposure limit set for an uncontrolled environment.

TYPHOON Q500 4K QUICK START GUIDE. Includes title page with logo, a detailed table of contents, and an overview page with numbered diagrams of the drone components and ST10+ controller buttons.

QUICK START GUIDE (continued). Includes table of contents, overview of drone parts, and overview of ST10+ controller buttons.