

Important safety information

Thank you for purchasing this SYMA product. To ensure that you operate the aircraft correctly, please read these instructions carefully before first use and store them in a safe place for future reference.

Safety information

- Keep the smaller-sized accessories out of the reach of children.
- This aircraft can move very quickly. When flying for the first time, push left joystick up slowly to prevent the aircraft from ascending too rapidly and causing damage or collisions.
- When the flight has ended, switch off the remote control before switching off the power on the aircraft.
- Do not store the battery in a hot environment (e.g. near open flames or a heating device).
- When the quadcopter is airborne, it should be kept at least 2-3m away from the pilot and other people to avoid the risk of a collision during landing.
- Children must be supervised by an adult when operating the aircraft. The aircraft should always remain within the line of sight of the pilot (or instructor).
- Do not recharge non-rechargeable batteries. When installing or changing the batteries, ensure that they are connected in the correct polarity. Do not mix old and new batteries or different types of batteries.
- Do not short circuit the battery terminals
- If you do not plan to use the quadcopter for at least 10 days, discharge the battery to 40%-50%, i.e. if the battery is fully charged, drive the quadcopter for half of the total driving time). This helps to prolong the lifespan of the battery.
- Maintain a safe distance from the spinning propellers to avoid the risk of injury.
- In order to prevent interference with air traffic control systems, it is forbidden to use remote controls within a 5000m radius of an airport runway (calculated from the centre of the runway). Always comply with remote control restriction orders issued by national authorities.
- You must only use the recommended transformer for this model. The transformer is not part of the model. Disconnect the model from the transformer or charger before cleaning with cleaning fluid. Regularly inspect the transformer's wires, plug socket, outer casing and other accessories to ensure that they are not damaged. If there are any signs of damage, discontinue use immediately until the fault has been repaired.
- After use, ensure that the quadcopter and remote control are switched off and remove the batteries in the remote control.
- The packaging and this manual contain important information and should be kept in a safe place for future reference.
- Do not look directly at the laser beam.
- A reminder that the toy must be used with caution since skill is required in order to control the flight and avoid collisions with the user, objects or third parties.
- Precautions to be observed such as "Do not touch the rotating rotor, avoid loose clothing or hair that could be caught in the rotor, do not fly near the face"
- Advice to adult supervisors to teach children how to safely fly and control the toy.
- Conditions to be observed when using the toy

Repair and maintenance

- Clean the product regularly with a clean, soft cloth.
- Avoid exposing the product to direct sunlight or heat.
- Do not submerge the product in water, as this may damage the electrical components.
- Regularly inspect the propellers, motor and battery. If there are any signs of damage, discontinue use immediately until the fault has been repaired.

About this product

Specifications

• Aircraft	
Weight Aircraft	Approx. 67 g
Specifications	3.11x2.93x53.6 mm
Flight range	Approx. 30 m
Flight Altitude	Approx. 10 m
Flight time	Approx. 10 mins
Motor	e6
Battery	3.7 V, 400 mAh
Battery Charging time	Approx. 60 min

• Remote control	
Operating frequency	2.4 GHz
Operating temperature	0°Cto 40°C

Package contents

Aircraft	1
Remote	1
Phone holder	1
USB charging cable	1
Propeller	4 (A/B)
Propeller protector	2
User manual	1

Download the SYMA FLY app and watch the video tutorial

Installing the SYMA FLY app
Scan the QR code with your mobile device or download the app from your app



* Note: For best results, use a device with iOS 8.0/Android 5.0 or later.

Aircraft components

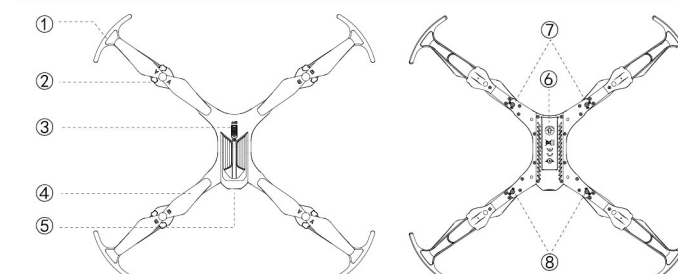

- ① Propeller protector
- ② Motor
- ③ Power switch
- ④ Propellers
- ⑤ Lens
- ⑥ Battery cover
- ⑦ Rear indicator
- ⑧ Front indicator

Remote control components

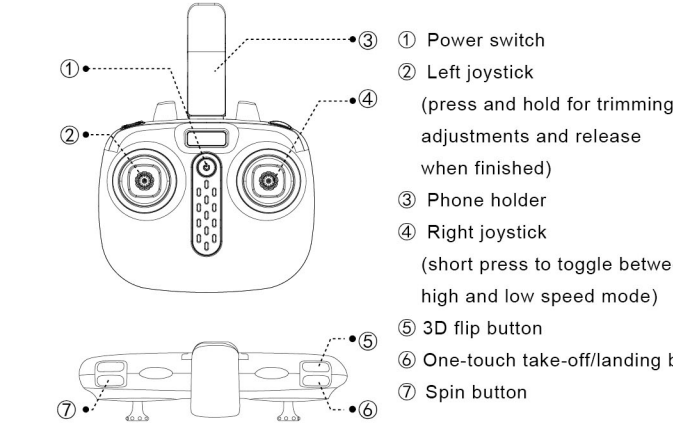

- ① Power switch
- ② Left joystick (press and hold for trimming adjustments and release when finished)
- ③ Phone holder
- ④ Right joystick (short press to toggle between high and low speed mode)
- ⑤ 3D flip button
- ⑥ One-touch take-off/landing button
- ⑦ Spin button

User Manual

Accreditation standard: GB/T28701-2011

The materials, specifications, parts and packaging mentioned in this manual are for reference purposes only. We are not responsible for any changes made to this printed material, nor are we able to inform customers of any updates or changes. Please refer to the SYMA Toys website for the latest information.

Assembling the product

Folding the quadcopter

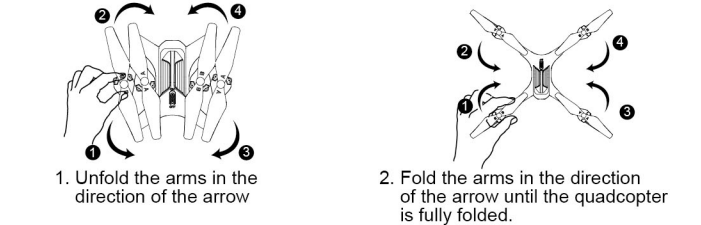

Detaching the propellers

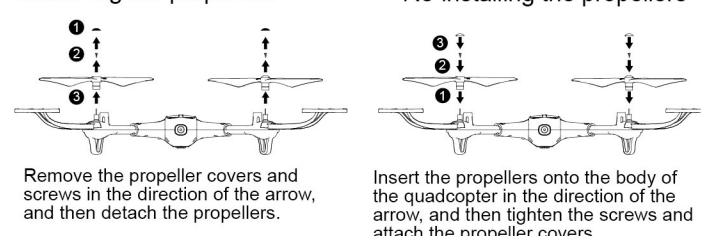

Note: The propellers are labelled 'A/B'. Ensure that each propeller is inserted in the corresponding position on the arms, and then tighten the screw, and then tighten the screws and attach the propeller covers.

Installing the propeller protectors

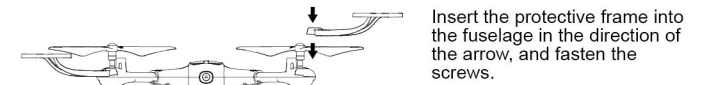

Attaching the phone holder

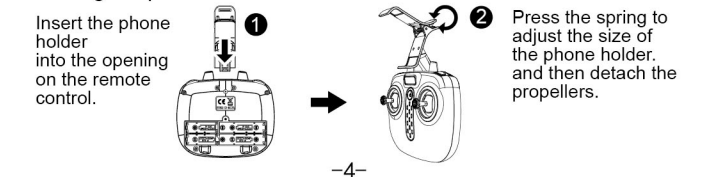

Stunt functions

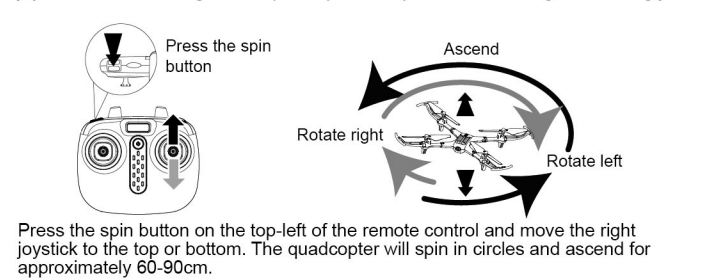
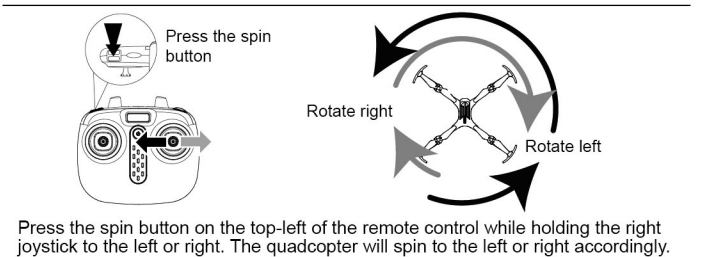

Trimming

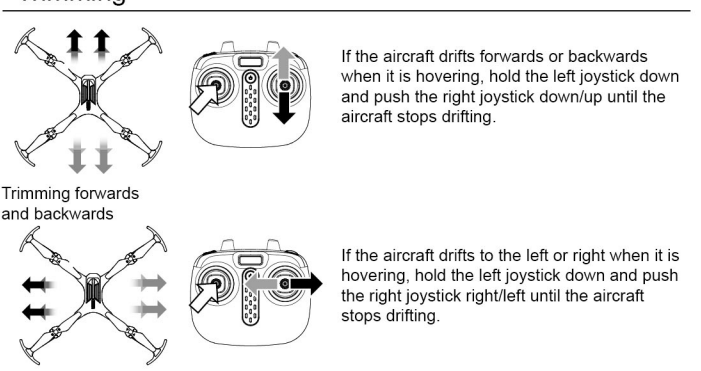

Charging the aircraft battery

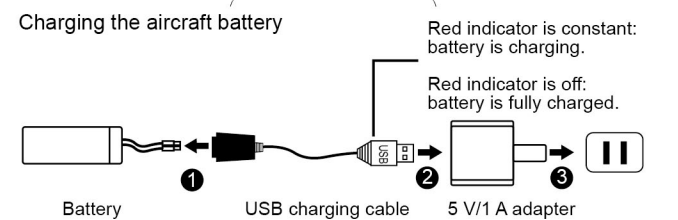
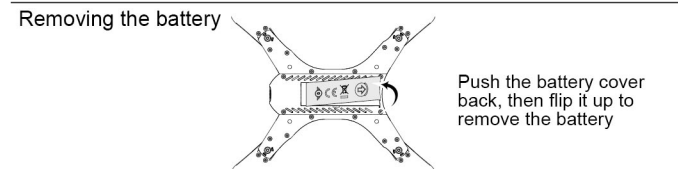

* Charge the quadcopter with the USB charging cable that came with the product.
* Using adapters with a lower rated current will result in a longer charging time.

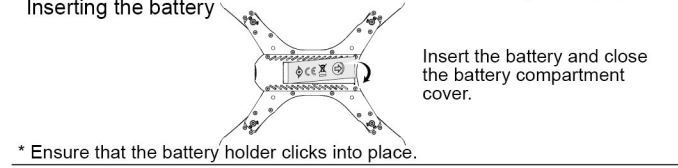

* Ensure that the battery holder clicks into place.
* The toy is only to be connected to Class II equipment bearing the symbol

- Do not short circuit or compress the battery, as this may cause an explosion.
- Do not disassemble the battery or store it in a hot environment.
- If you do not plan to use the aircraft for at least 10 days, discharge the battery to 40%-50%. This helps to prolong the lifespan of the battery.
- Rechargeable batteries should be removed from the aircraft before charging.
- Rechargeable batteries should only be charged under the supervision of adults, and keep away from flammable materials.
- Exhausted batteries should be removed from the aircraft.
- Caution: Risk of explosion if battery is replaced with incorrect ones, please install the batteries according to the instructions.

Inserting the remote control batteries

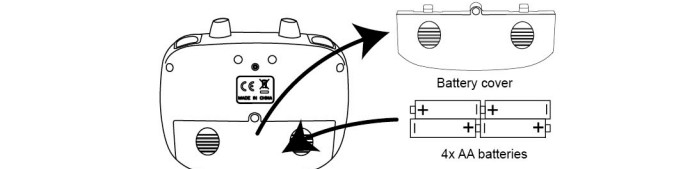

To insert the controller batteries, open the battery cover on the back of the remote control and insert 4x AA alkaline batteries, ensuring that you observe the polarity markings (batteries are not included and must be purchased separately).

- When installing the batteries, ensure that you match the + and - ends of the battery with the + and - signs on the controller.
- During the battery installation, it must be ensured that the polarities of the batteries are matched with that of the battery box. No battery shall be installed with the opposite polarity.
- Please do not use new and old batteries together.
- Please do not use different types of batteries together.
- Do not use rechargeable batteries.
- Exhausted batteries are to be removed from the Remote control.
- Rechargeable batteries are to be removed from the toy before being charged.
- Rechargeable batteries are only to be charged under adult supervision

Flight preparation and turning the aircraft on/off

Pairing the remote control with the aircraft

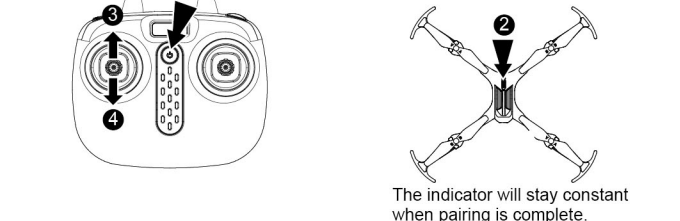

After you switch on the remote control, the indicator will flash quickly to indicate that the remote control is waiting to pair with the quadcopter.

Turning the quadcopter on

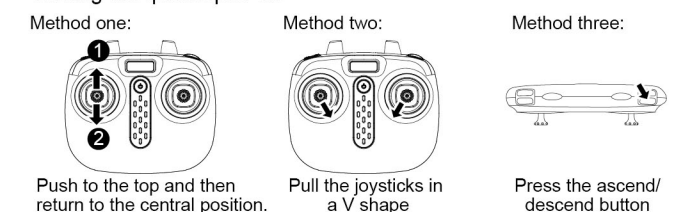

Note: 1. If the aircraft is flown out of range from the remote control, the aircraft indicator light will start to flash and the aircraft will land slowly.
2. If the remote control suddenly turns off or runs out of power during flight, the aircraft will automatically land and come to a stop. If the remote control is turned back on during this process, you will be able to control the aircraft again.

Turning the quadcopter off

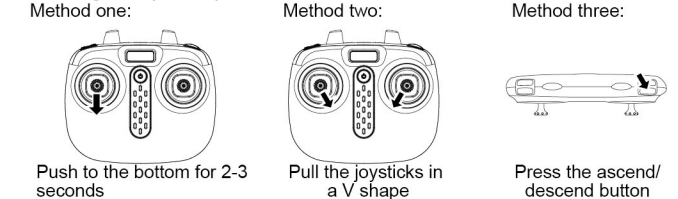

Using the remote control

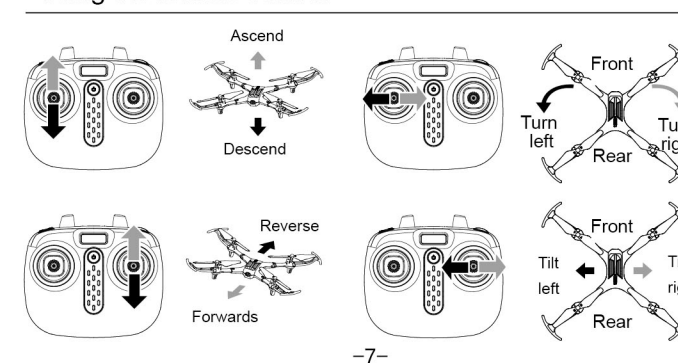

Accessories (available separately)

The following section contains a list of optional accessories that are available to purchase. Accessories can be purchased from your local retailer. Please indicate your preferred colour when making your purchase.

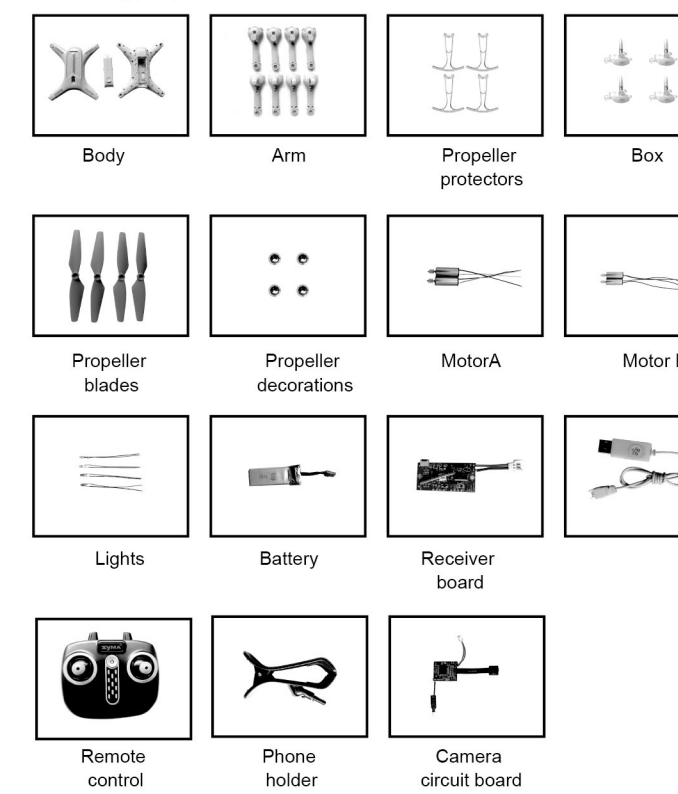

Stunt functions

Undervoltage protection
A flashing red indicator light on the base of the aircraft indicates that the battery level is low. When this occurs, bring the aircraft back to land.

Overcurrent protection
If the aircraft's blades collide with another object or become stuck, the aircraft's circuit will engage the overcurrent protection mechanism.

Level calibration
Place the aircraft on a level surface and move the left and right joysticks to the lower right corner for approximately 3 seconds. The indicator will flash rapidly and then stay constant to indicate that the calibration process is complete.

High/low speed mode
Briefly press the right joystick to switch between high and low speed mode.
1. Low speed mode is enabled by default when the aircraft is switched on.
2. The remote control beeps twice when high speed mode is enabled and once when low speed mode is enabled.

One-touch take-off/landing
Once you have mastered the basic controls, you can try performing some flip manoeuvres. Start by flying the quadcopter to an altitude of at least 3 m. Then hold down the button on the top-right corner of the remote control (flip button) and push the right joystick all the way up/down/left/right to flip the aircraft forward/backwards/left/right.

1. When the aircraft is in standby, press the take-off button to make the aircraft take off automatically and hover at a height of 1.5 m.
2. When the quadcopter is in the air, press the one-touch take-off/landing button to make the aircraft land automatically.

Atmospheric pressure positioning
When you release the left joystick (throttle) after ascending/descending, the quadcopter will continue to hover at the current height.

1. Define the front
When the aircraft is powered on for the first time, the direction of the aircraft nose is straight ahead.
2. Start headless function

Headless mode
After the linking is completed, press and hold the right joystick (about 2S), the remote controller will emit a "dididi..." sound, and the indicator light on the aircraft will flash slowly, indicating that it has entered the headless state; press and hold the right joystick again (about 2S). When you hear a long beep, you will exit the headless state. In the headless state, the controller does not need to identify the position of the aircraft's nose, but only needs to control the aircraft according to the direction of the joystick of the remote control.

Define the positive direction function correction:
When the aircraft collides with a headless state, if you find that the fixed head direction is deviated, you only need to re-orient the aircraft and move the left and right joysticks of the remote control to the lower left at the same time. When the indicator on the aircraft flashes slowly 3 A long light after a second indicates that the calibration is complete.

Real-time transmission function

1. Download and install the app.
If you have an Android device, download the SYMA FLY app from the Syma website (www.symatoys.net), or scan the QR code shown.
If you have an IOS device, download the SYMA Fly app from the Apple App Store, or scan the QR code shown.

Note: The QR code is printed on the packaging and on the back cover of the user manual. Visit the Syma website or your app store to download the latest version of the SYMA Fly app.

2. Follow the in-app instructions

Warning: Changes or modifications to this unit not expressly approved by the party responsible for compliance could void the user's authority to operate the equipment.

NOTE: This equipment has been tested and found to comply with the limits for a Class B digital device, pursuant to Part 15 of the FCC Rules. These limits are designed to provide reasonable protection against harmful interference in a residential installation. This equipment generates, uses and can radiate radio frequency energy and, if not installed and used in accordance with the instructions, may cause harmful interference to radio communications. However, there is no guarantee that interference will not occur in a particular installation. If this equipment does cause harmful interference to radio or television reception, which can be determined by turning the equipment off and on, the user is encouraged to try to correct the interference by one or more of the following measures:
• Reorient or relocate the receiving antenna.
• Increase the separation between the equipment and receiver.
• Connect the equipment into an outlet on a circuit different from that to which the receiver is connected.
• Consult the dealer or an experienced radio/TV technician for help.

This device complies with FCC radiation exposure limits set forth for general population (uncontrolled exposure). This device must not be collocated or operating in conjunction with any other antenna or transmitter.

RF frequency band : 2445MHz-2475MHz
Transmitter power : 3.55dBm(Max.)
WiFi frequency band: 2412-2472MHz
WiFi power: 13.88dBm(Max.)
Sold to EU country
product name: [Folding quadcopter]
model number: [Z4W]
Brand name :SYMA
Contact person: Ivan
Tel:+86-0754-86381701

Hereby, [GUANGDONG SYMA MODEL AIRCRAFT INDUSTRIAL CO., LTD.] declares that this [aircraft] is in compliance with Directive 2014/53/EU The full test of the EU declaration of conformity is available at the following internet address:
http://www.symatoys.com/download/declaration-of-conformity.html
SIMPLIFIED EU DECLARATION OF CONFORMITY

Manufacturer:
Guangdong SYMA Model Aircraft Industrial Co., Ltd.
Address: 2 West Xingye Rd, Lamei Industrial Area, Chenghai, Shantou, China
Postal Code: 515800
Sales department: +86 0754 86980668
After-sales service: +86 0754 86395095
Fax: +86 0754 86395098
Website: www.symatoys.com
Email: syma@symatoys.com



The company has the right of final interpretation of this user manual.